

ASSEMBLY INSTRUCTIONS

METAL POINT 2 SHELVING

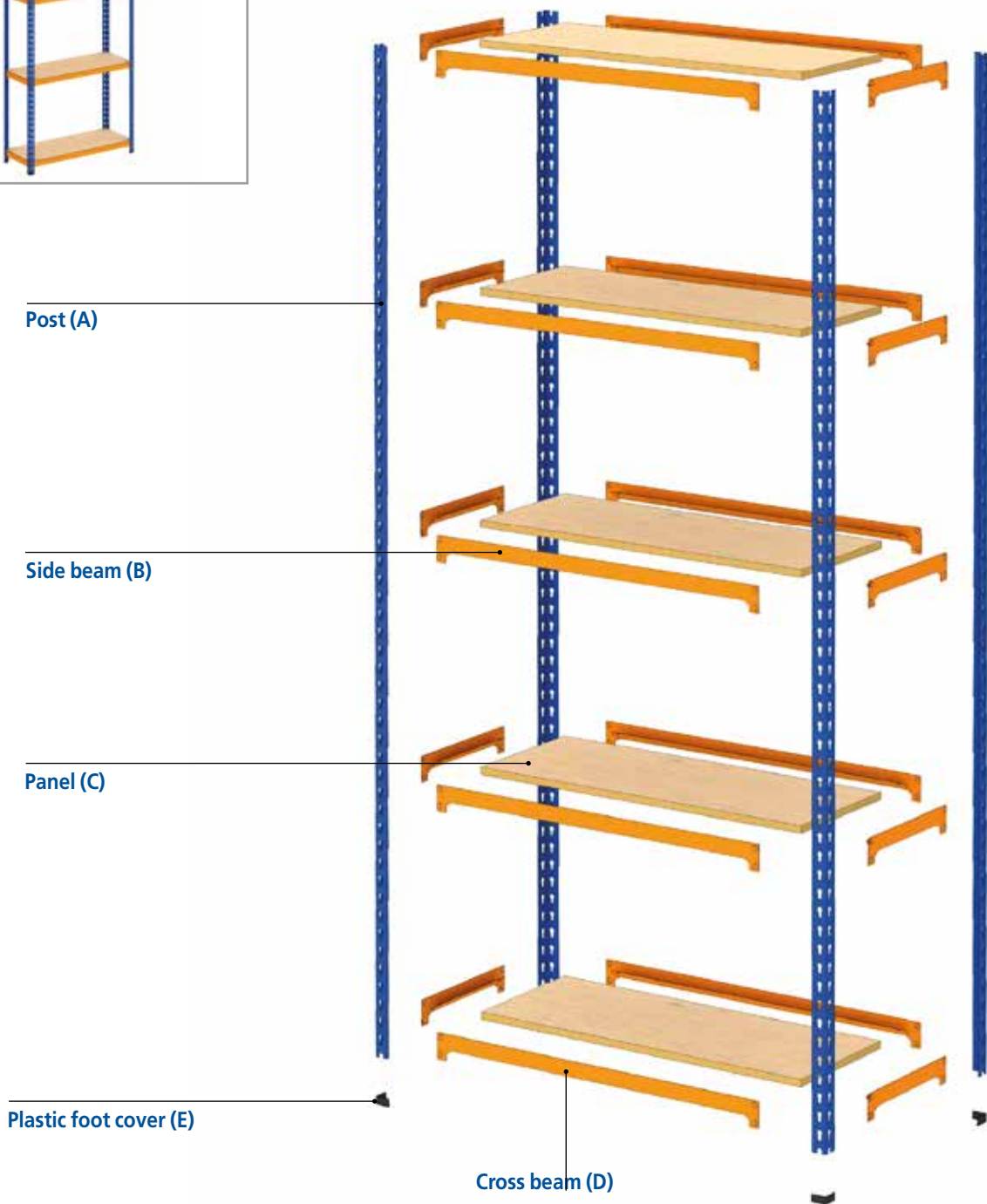

Assembly of the structure

1

First, place the plastic foot cover (E) on the bottom of each post (A).

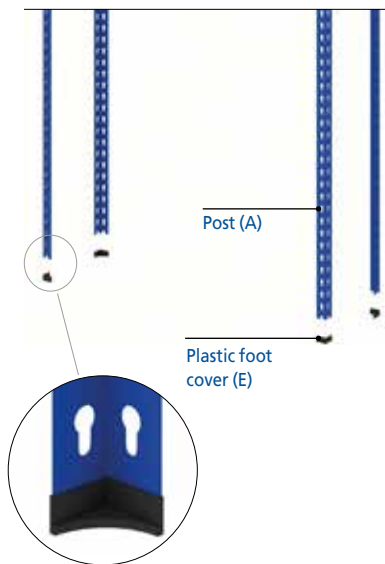

2

To put the structure of the rack together, first position the lower side beams (B) using a nylon mallet. Next, do the same with the upper side beams (B).

Before tapping the pieces, make sure that the side beams (B) are placed at a 90° angle with respect to the post (A).

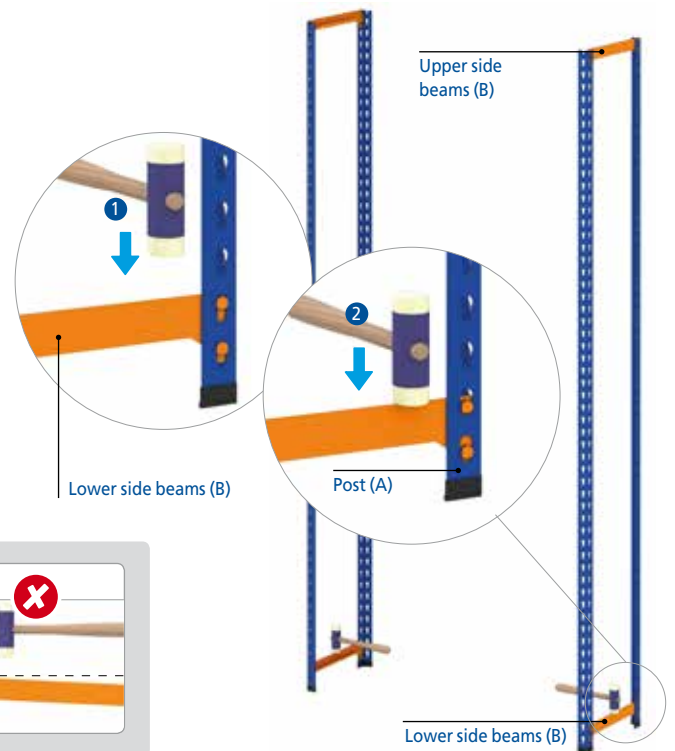
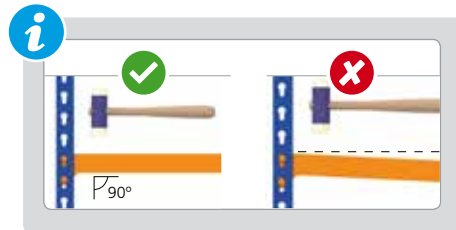

3

Once installed, place the four remaining levels of side beams (B).

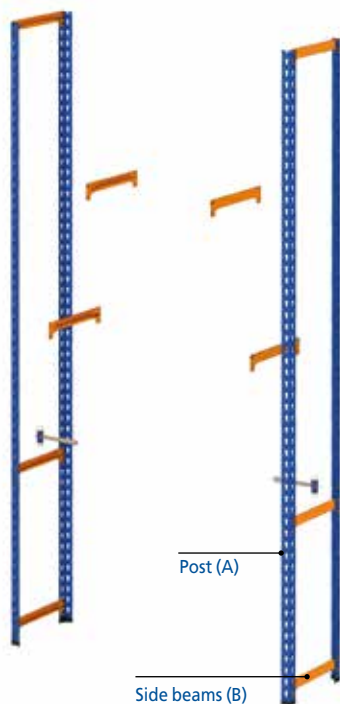

4

Next, attach the cross beams (D) of the lower level in the same manner as the side beams (B), and check that they are positioned at the same level.

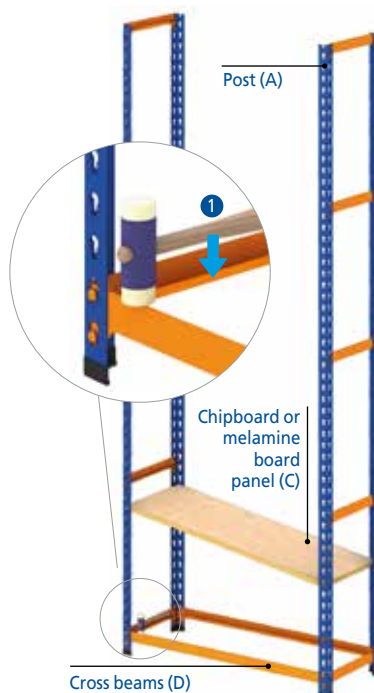

5

Before placing all the cross beams, insert the shelf (C). Then, mount the next level and, so forth, from bottom to top.

